



COMPANY PROFILE

Member of the
**SIMONSWERK
GROUP**

STRUCTURAL GLASS AND ARCHITECTURAL SOLUTIONS

SADEV is a company specialized in **building envelope** solutions and **structural glass balustrades**. With expertise developed since 1938, it is a market leader thanks to its **CLASSIC** and **SABCO** product ranges. The company is deeply committed to **innovation, durability, and quality**.

With a growing **international presence**, an extensive sales network, and a strengthened team, SADEV supports its clients at every stage of their projects, providing **bespoke solutions and personalized support**. Its solid financial foundation enables the company to take part in **large-scale architectural projects worldwide**.



OUR STORY

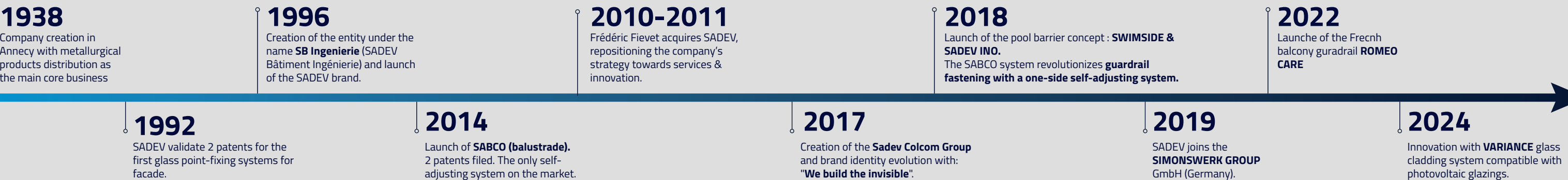

SIMONSWERK GROUP

Rooted since 1889 in Rheda, Germany, the SIMONSWERK GROUP has grown into a global leader in premium hinge systems.

Innovation, trusted partnerships, customer focus, and a relentless pursuit of excellence are the core values that drive the group.

SIMONSWERK GROUP is committed to sustainable, profitable growth delivering smart, efficient, and durable solutions centered around quality and performance.

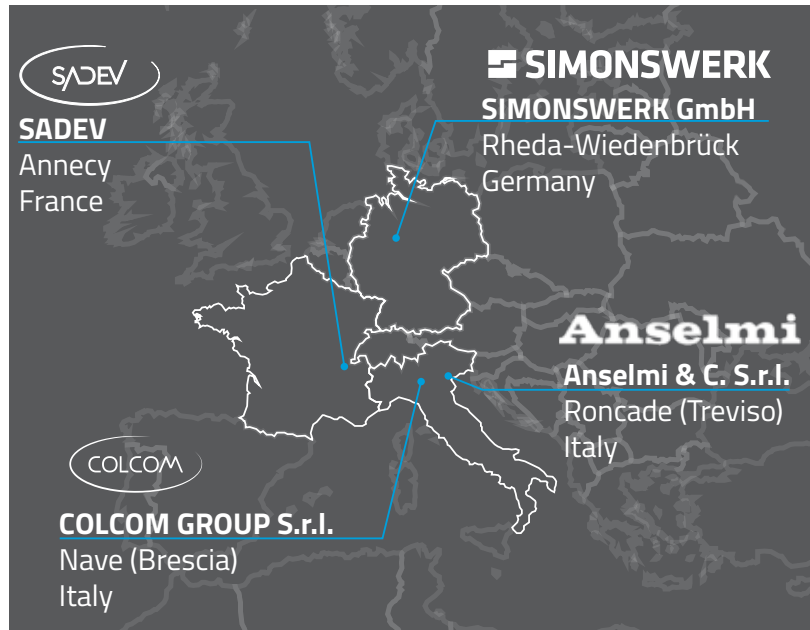

"Our international cooperation and mutual success are based on our values."
Dr. Frank Remy, Chief Operations Officer



AN INTERNATIONAL PRESENCE FOR A CLOSER SERVICE

SADEV ensure a perfect supply chain management to secure an optimal service and delivery on a gloabl scale.

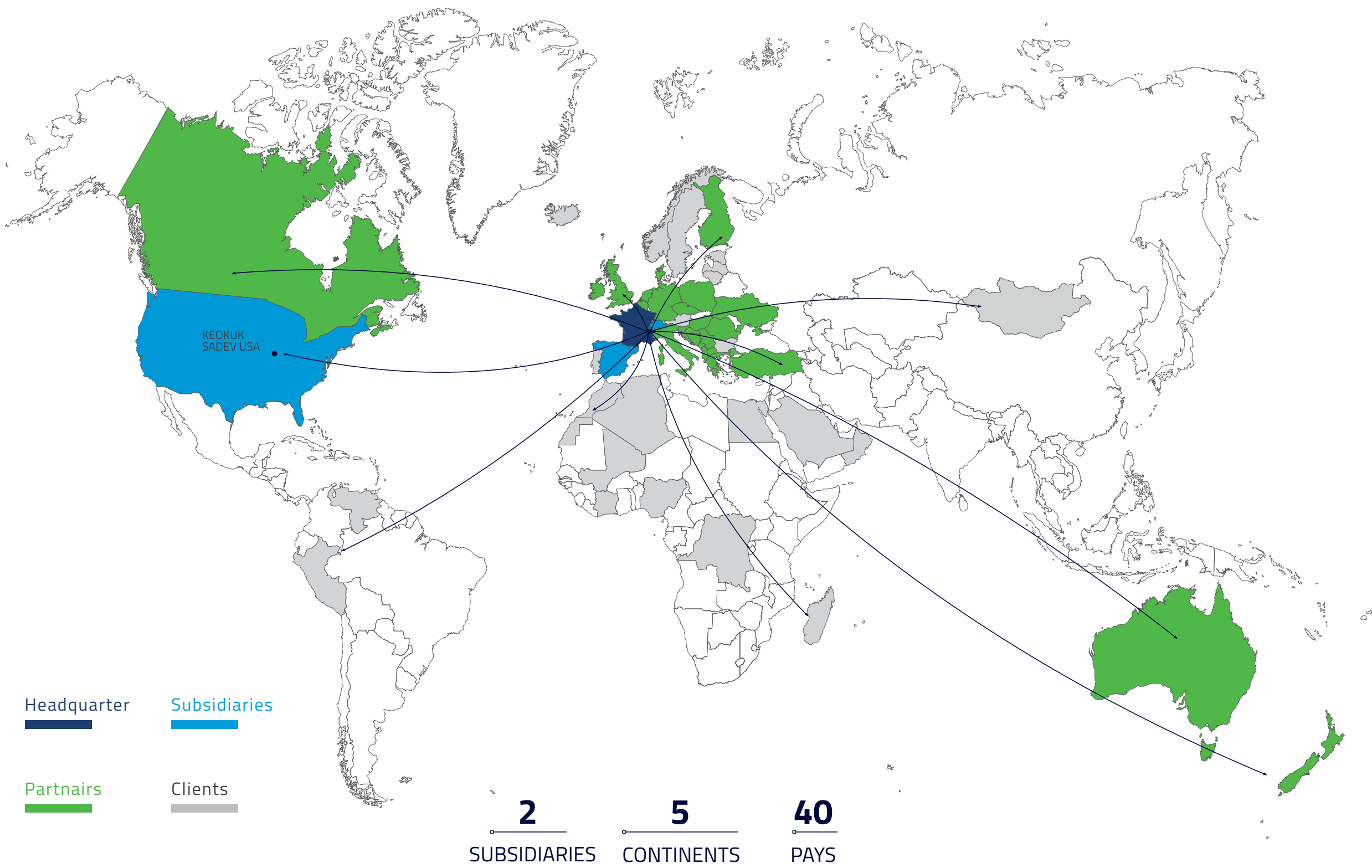

**SAIL TOWER - JEDDAH
(SAOUDIE ARABIA)**

Glass guardrail SABCO with calculation and specific tests for wind resistance, warm and arid climate.



AN EMBLEMATIC AIRPORT

DUBAI AIRPORT - UNITED ARAB EMIRATES

Point-fixing glass system
(spiders and swivels) for
the project facade.

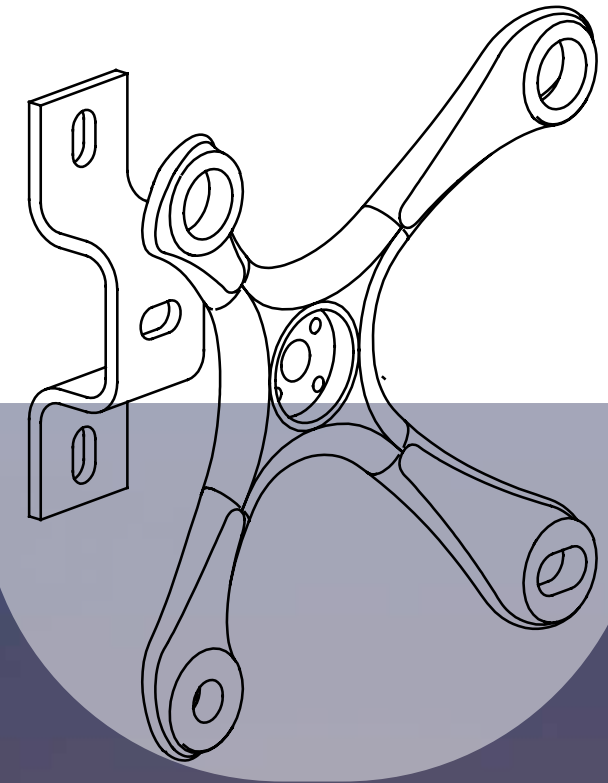

Dubai International Airport consists of three terminals.

Designed by architect Paul Andreu, it stands out for the distinctive shape of its dynamic facades, suggesting the shape of an airplane wing stretching over one kilometer.

DEDICATED TECHNICAL SUPPORT



Our expertise at your service for made-to-measure solutions

Our **design department**, made up of specialized **engineers and technicians**, supports you in **adapting** and/or **developing** bespoke solutions perfectly suited to your technical, aesthetic, and sustainability requirements.

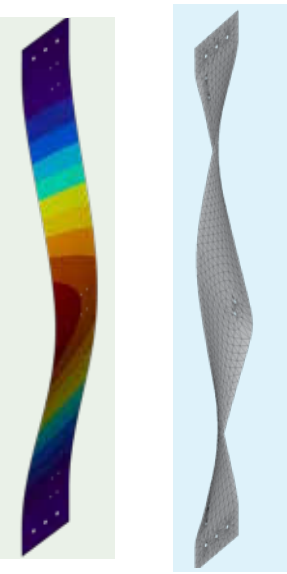

Our **engineers guarantee the performance and reliability** of every solution through a rigorous process: **design** validation, structural **calculations**, and advanced laboratory **testing** (static, dynamic, cyclic, durability, etc.). These tests are carried out both in our own in-house lab and in collaboration with **certified laboratories** to ensure the highest **standards conformity**.

From **design** to on-site installation, our teams support you on each stage including dedicated training for your staff.

Thanks to this our expertise, we can also manage the entire Experimental Technical Assessment process for you, ensuring full regulatory compliance.



173 BOULEVARD HAUSSMANN

Optimisation des méthodes de fabrication de la structure avec intégration d'un système photovoltaïque et optimisation des pinces qui maintiennent les écailles de verre.

Pince de fixation sur-mesure

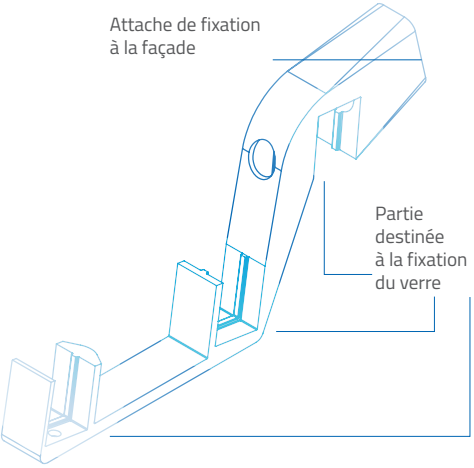

OUR PATENTS

2014 Double Side Wedges 	2016 Spiders for point-fixing system 	2019 One Side Wedge 	2021 Variance®P 	2022 Romeo®Care
2014 Swivel fittings 	2018 INO® 	2020 OSF system 	2022 Height adjustment wedge 	2023 Variance®C

OUR RANGES

GLASS FACADES SOLUTIONS

CLASSIC®

POINT-FIXING GLASS SYSTEM

Structural glass remains at the core of SADEV's expertise and original craft. We offer both custom-made solutions (with our CONSTRUCT range) and standard systems (with our CLASSIC range), ensuring simple, precise, and aesthetic installation for all type of facades. We aim at maximizing natural light and energy efficiency for commercial, residential and public buildings.

What sets structural glass apart is its ability to support significant loads while maintaining complete transparency. SADEV has built strong expertise in this field, particularly through point-fixed glass systems, available in both single-skin and double-skin configurations.

Our design office works closely with you to develop and optimize bespoke solutions that meet your specific requirements of each architectural project.



SAINT-GOBAIN TOWER - PARIS - FRANCE

Design and delivery of specific spiders and point fixing part for this ambitious glass facade project.

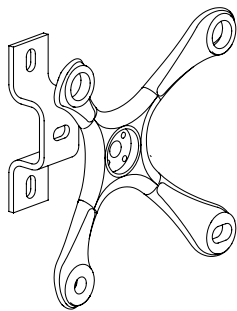

UGC - VELIZY - FRANCE

Design and delivery of specific spiders and swivels for this 20m high glass sphere.



VARIANCE® C

GLASS CLADDING SYSTEM

Since 2022, we have developed a fastening system for the installation of glass cladding.

Driven by our market insight, adaptability, and spirit of innovation, we aim at meeting evolving demands and environmental challenges.

With the introduction of new environmental regulations, the demand for external thermal insulation has increased significantly. As a result, glass cladding is becoming a key element in tomorrow's architectural projects combining thermal performance with architectural freedom, thanks to the unique advantages of glass.

High-performance and aesthetic fixing systems !

PARISTECH - PARIS - FRANCE

1st concept of glass cladding system with its invisible fastening solution

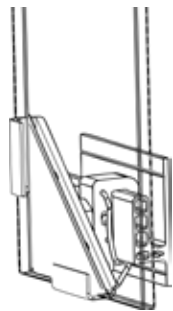
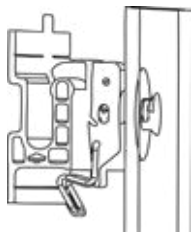

PARISTECH - PARIS - FRANCE

NOS GAMMES

GLASS SUNSHADING SOLUTION

ICARE®

GLASS SOLAR SHADING

Much more than sunshade systems, **ICARE** offers **tailor-made support**, closely aligned with the specific needs of your project. Our **design office** works beside you to **adapt or develop bespoke solutions** that meet your technical requirements delivering results that are both aesthetically refined and built to last.

ICARE systems help optimize **thermal comfort** and **energy efficiency**, while preserving **natural light**. The integration of **photovoltaic panels** further supports the transition toward **passive or even energy-positive buildings**, in full compliance with current environmental regulations.

Thanks to our proven **expertise in structural glass**, our engineers can meet a wide range of needs from the simplest to the most complex configurations whether **horizontal** or **vertical**, **adjustable** or **fixed**, **bolted** or **clamped**, **straight**, **inclined**, or even **motorized**.



IMREDD, NICE - FRANCE



Vertical and horizontal Sunshades until 1.4 meters deep

Structural justification through calculation and FEM (Finite Element Method) analysis

Full support for Experimental Technical Assessment procedures.



A COLORFUL PROJECT

SHOPPING CENTER BEAUGRENELLE - PARIS

This shopping center in Paris's 15th arrondissement was renovated in November 2019 to accommodate the arrival of Galeries Lafayette on the upper floor.

Valode & Pistre Design rethought the architecture by drawing the new interior façade in a "glass origami in the colors of the sky." The project is rewarded with the BREEAM-IN-USE "Excellent" certification in 2021.

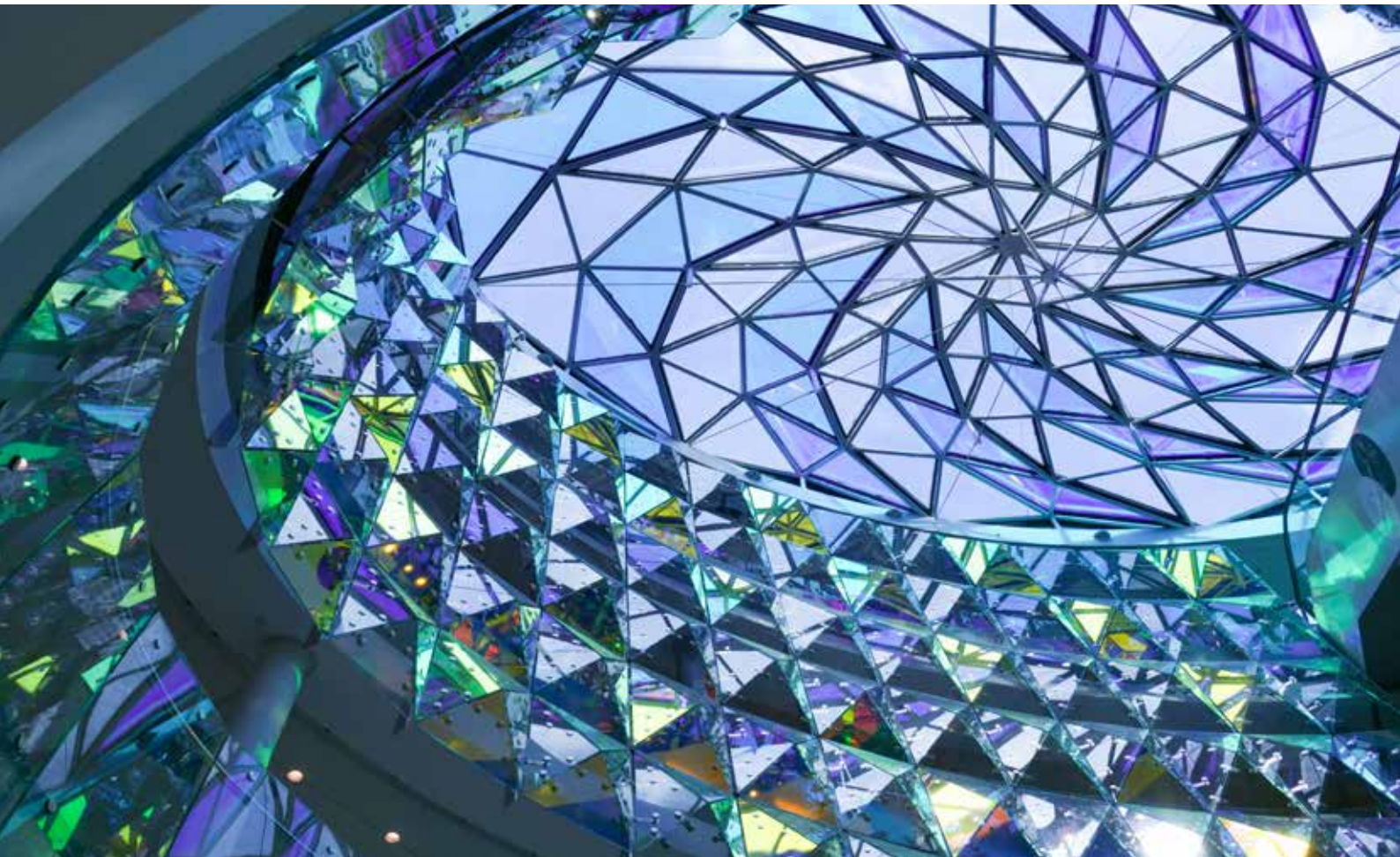

Research and study of aesthetic and performing solutions.
Design, modelling and production of specific facade parts
Verification by calculation and FEM (finite element method)

OUR RANGES

GLASS BALUSTRADE SOLUTIONS

SABCO®



GLASS RAILING SYSTEM

In the world of contemporary architectural design, our glass balustrades offer both aesthetic appeal and functional safety securing spaces while preserving panoramic views. They can be installed in various configurations floor mounting, side-mounting, or French-style giving architects and designers the freedom to fully express their creativity.

Additionally, the glass can be treated to add textures, colors, or patterns, providing lots of customization possibilities.

Other ranges complete our offer such as OSF, a compact and high-performance system delivering excellent value for money. Swimside enhances our portfolio with pool protection systems that meet the sector's most demanding safety standards.



OSF®

SWIMSIDE®



ROMEO CARE®

JULIET BALCONY SYSTEM

As a demonstration of our strong R&D capabilities and expertise in balustrade systems, we have developed a dedicated fixing solution for Juliet balconies (also known as window guardrails).

Our design office engineered an innovative system that combines ease of installation, high performance, and refined aesthetics fitting with our commitment to smart, functional design.

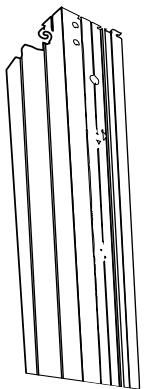

THE HIGHEST RESIDENTIAL BUILDING IN DANMARK

LIGHTHOUSE 2.0

This residential complex of 400 units is located at the edge of Aarhus Island. Designed by the architects studio 3XN, it is made of the Fyrtårnet tower, rising 142 meters high, along with two lateral buildings - Kanalhuset and Promenadehuset.

The development stands as a lighthouse for all of Aarhus, with a high-rise building and small clusters of terraced houses.



- 4 000 meters of SABCO guardrails, including 800 meters of curved railing with different radius and glass balcony partition.
- A bespoke solution with specific drilling and a corrosion-resistant anodized finish for seafront installations





VARIANCE[®] CLASSIC[®] DECOR[®] ICARE[®] CONSTRUCT[®]
PRIVACY[®] OSF[®] ROMEO[®] SABCO[®]
SWIMSIDE[®]

Member of the
**SIMONSWERK
GROUP**

Tél. +33(0) 4 50 08 39 00 | info@sadev.com
76, chemin des Poses - 74330 Poisy (France)

[sadev.com](https://www.sadev.com)
suivez-nous sur

